

Barovac

Closed Wound Drainage System

What is Barovac

BAROVAC is the drainage and continuous aspirators that intends to press out body fluids, pus, serum or the like comes from incised wounds due to the surgical operation or others. It helps to heal the incised wounds to minimize an infection and unpleasant feeling and narrow the wounds region.

It is kind of continuous drainage collection vessel which removes unhelpful alien substances filled by fluid and plasma in affected area.

It is very effective to reduce the antibiotic on account of removing the alien substances rapidly. There is a variety of specifications to use easily.

(Operating room, Intensive care unit, Orthopedics, Neurosurgery, General surgery, Gynecology, Otorhinolaryngology, Thoracic surgery, Dentistry)

After surgery, some patients require wound drains. The wound drain is inserted while the patient is in the operation room receiving general anesthesia. The purpose of the drain is to remove fluid and/or blood from the surgical site. This helps the healing process and shorten healing time.

Barovac has a various container volume and the type of wound tube according to the intended use & the way of using for customer's need.

Barovac Closed Wound Drainage System

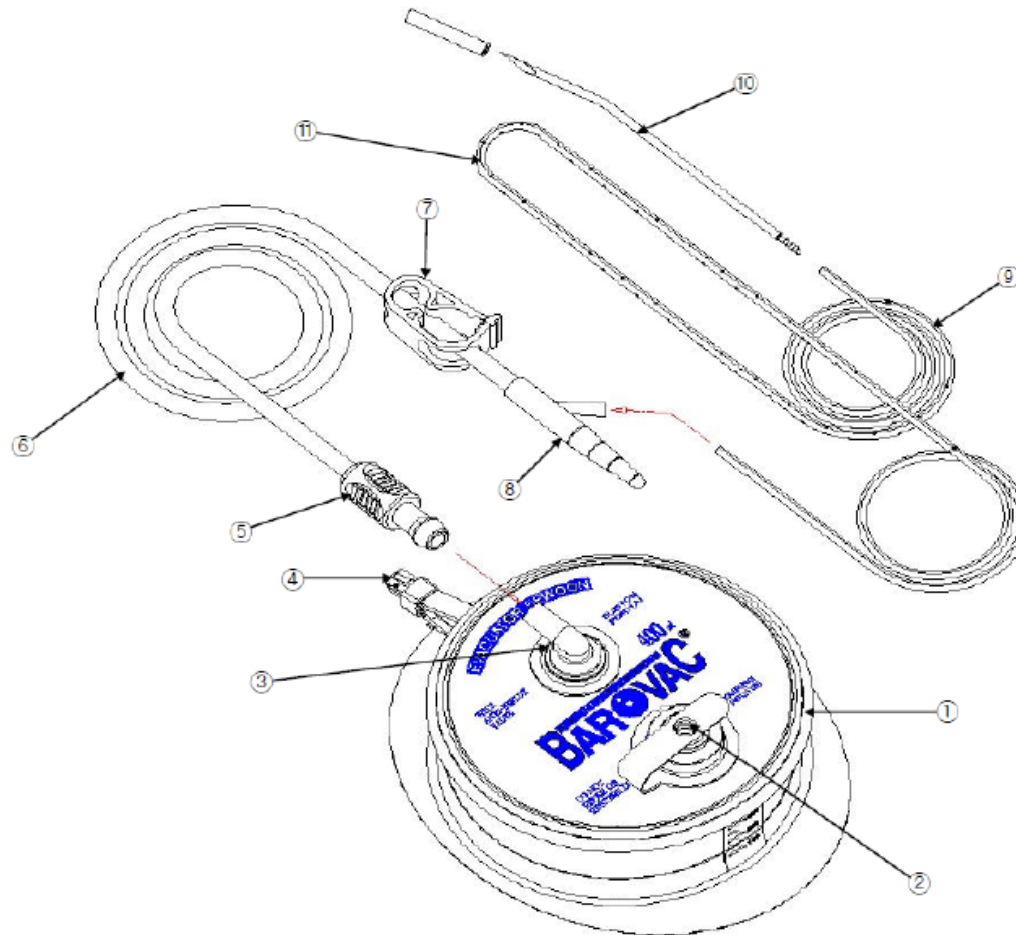

Characteristic

1. The transparent ①Evacuator Container's side vinyl provides the visual inspection for checking condition of discharge during the surgical operation
2. There is the multiplicity of selection for container capacity according to the aim to use.
3. The device is portable because ①Evacuator Container is able to hang on patient's bed sheet, gowns and others with pinch clamp.
4. The design of ⑤Connector that is located at the end of ⑥Connecting Tube, has strong coherent when connecting with ③Suction Port, so it reduces the risk of putting ⑥Connecting Tube out and leak.
5. ⑦Pinch Clamp is able to control the rate of drainage.
6. ⑧Y-Connector is able to connect one or two ⑨Wound Tube(s) according to usage.
7. The size and type of ⑨Wound Tube are diversified to be able to use appropriately according to the condition of affected part and the volume of discharge.

Characteristic

8. ⑨Wound Tube is designed to retain constant absorption force even though it is during kinking problem.
9. After suture of wound, ⑪X-Ray Opaque Line makes possible to check the position and inserted condition of ⑨Wound Tube with X-ray.

Caution

1. Single use only
2. This device should be use by physicians properly trained.
3. Do not use any damaged product of package or appearance.
4. Do not use for other purpose except for the product that is supposed to use its own object.

Procedure

1. After checking any damage product of package or appearance and expiry date, open the package just prior to using it.
2. Open the sealed package and take out the ⑨Wound Tube that is connected ⑩Trocar Needle.
3. Set the ⑨Wound Tube on the affected part with ⑩Trocar Needle.
4. After suture of wound, insert ④Connecting Tube into ③Suction Port of ①Evacuator Container.
5. Connect ⑨Wound Tube with ⑥Connecting Tube, and then press down the upper plate of ①Evacuator Container by both hand so as to reach bottom plate and close the plug of ②Pouring Spout in a hole.
6. Leave the device and check that an aspiration work is normal or not.
7. When drainage is full-filled in ①Evacuator Container, push and tighten ⑦Pinch Clamp with ④Connecting Tube and open the plug of ② Pouring Spout and throw away it.
8. Perform Step 5 again and untie ⑦Pinch Clamp after then drain the body fluid or others of wound continuously.

1. After checking any damage product of package or appearance and expiry date, open the package just prior to using it.

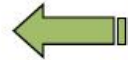
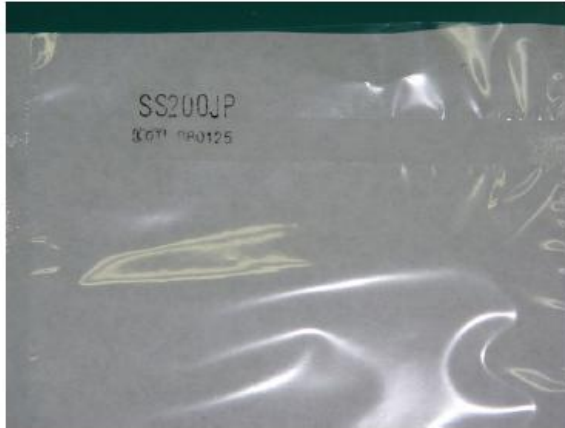

2. Open the sealed package and take out the ⑨Wound Tube that is connected ⑩Trocar Needle.



3. Set the ⑨Wound Tube on the affected part with ⑩Trocar Needle.

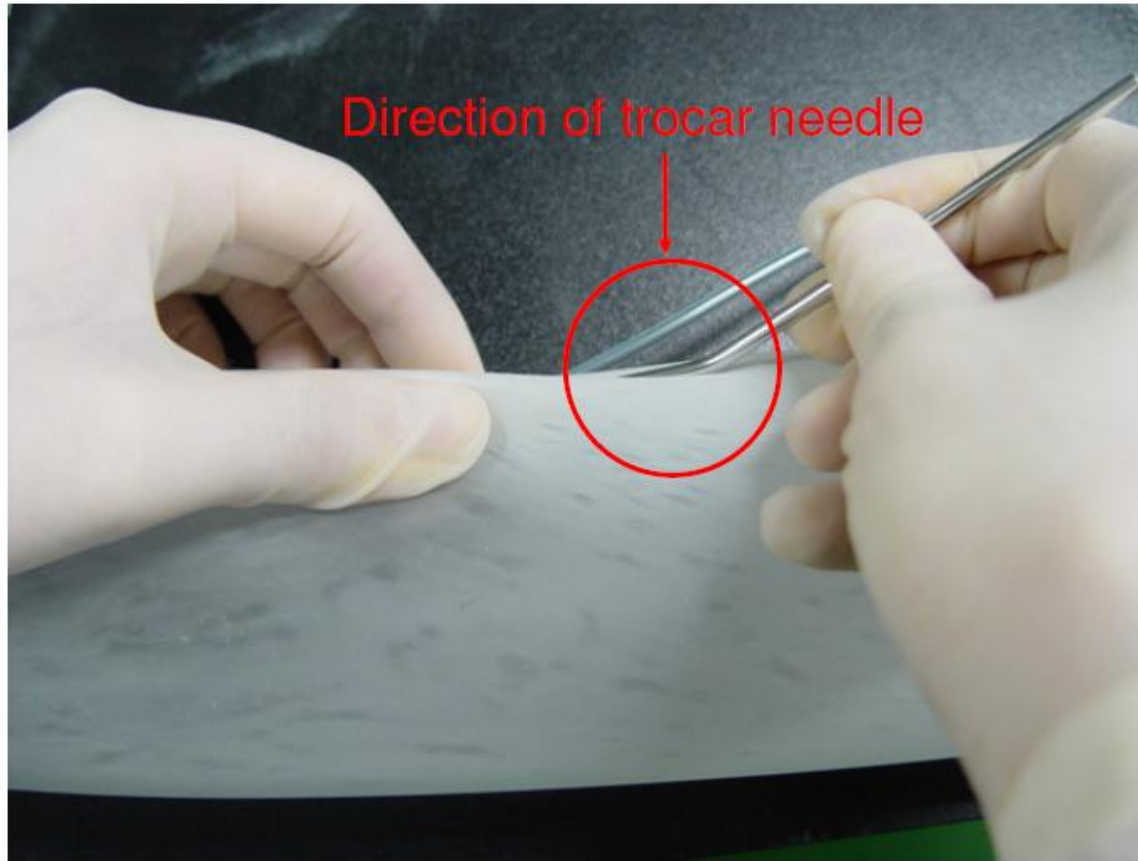

4. After suture of wound, insert ④Connecting Tube into ③Suction Port of ①Evacuator Container.



5. Connect ⑨Wound Tube with ⑥Connecting Tube, and then press down the upper plate of ①Evacuator Container by both hand so as to reach bottom plate and close the plug of ②Pouring Spout in a hole.



6. Leave the device and check that an aspiration work is normal or not.

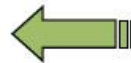
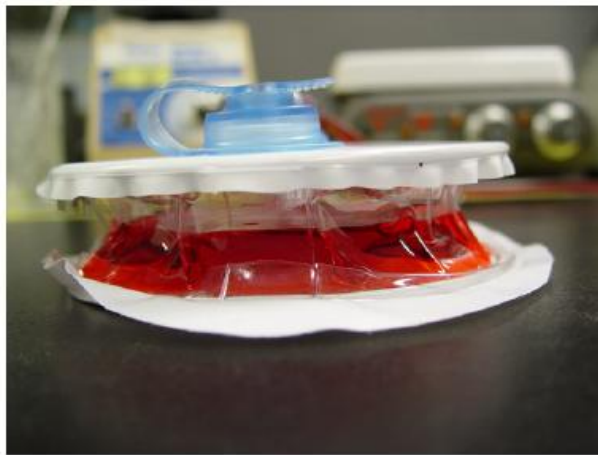

7. When drainage is full-filled in ①Evacuator Container, push and tighten ⑦Pinch Clamp with ④Connecting Tube and open the plug of ② Pouring Spout and throw away it.

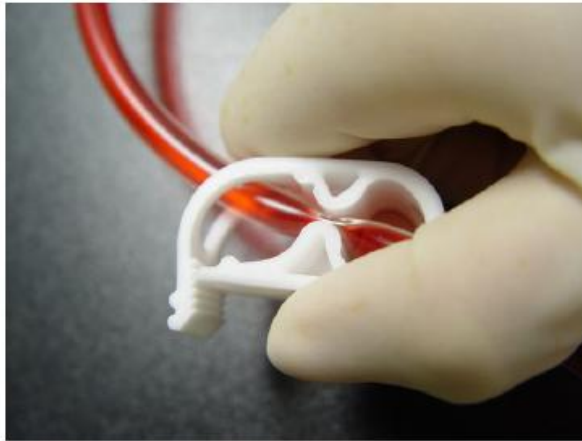

8. Perform Step 5 again and untie ⑦ Pinch Clamp after then drain the body fluid or others of wound continuously.

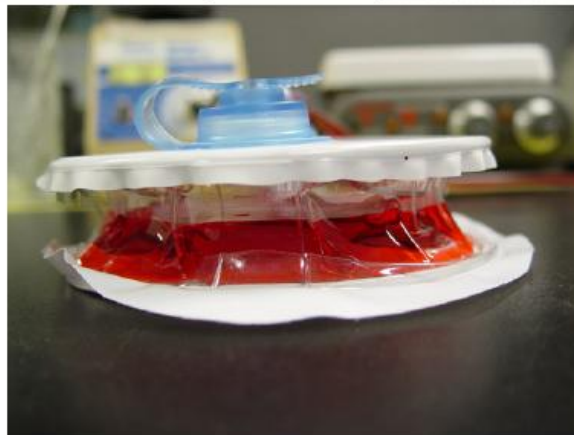
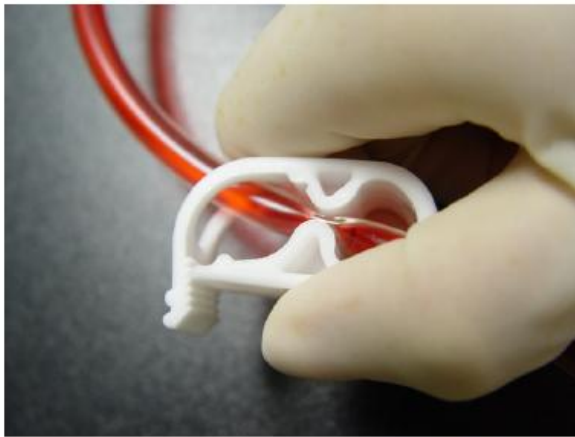

Specifications _ Barovac PP, PS Type



REF	CONTAINER CAPACITY	WOUND TUBE		REMARK
		I.D.(mm)	O.D.(mm)	
PP200M	200mL	1.6	3.2	Low Vacuum Craniotomy Kit
PP400M	400mL	1.6	3.2	
PP400C	400mL	1.6	3.2	
PP400L	400mL	3.2	4.8	
PP800L	800mL	3.2	4.8	

REF	CONTAINER CAPACITY	WOUND TUBE		REMARK
		I.D.(mm)	O.D.(mm)	
PS200C	200mL	1.6	3.2	Low Vacuum Craniotomy kit
PS400M	400mL	1.6	3.2	
PS400L	400mL	2.8	4.8	
PS800L	400mL	2.8	4.8	

EVACUATOR CONTAINER

- Material : PVC
- Three volume containers in accordance with suction purpose : 200/400/800mL

WOUND TUBE

- Material : PP Type-PVC, PS Type-All Silicone
- Length : 1200mm

Y-CONNECTOR

- Material : PVC
- For the purpose of 2way Suction

TROCAR NEEDLE

- Material : Stainless steel
- Length : 130mm

CONNECTING TUBE

- Material : PVC
- Length : 720mm

P-PVC Container

P-PVC Wound Tube

S-Silicone Wound Tube

200,400,800 – Container Capacity

C-Craniotomy

M-Medium (3.2mm)

L-Large (4.8mm)

Negative Pressure : 90mmHg

Low Vacuum Craniotomy Kit : 50mmHg

Specifications _ Barovac SS Type



REF	CONTAINER CAPACITY	WOUND TUBE		REMARK
		I.D.(mm)	O.D.(mm)	
SS100M	100ml	1.6	3.2	With Connecting Tube & 2-WAY P.C.Connector
SS100L		2.8	4.8	
SS100JP		2.8	4.8	
SS200M	200ml	1.6	3.2	
SS200L		2.8	4.8	
SS200JP		2.8	4.8	

EVACUATOR CONTAINER

- Material : All-Silicone
- Five volume containers in accordance with suction purpose : 100/150/200/250/400mL

WOUND TUBE

- Material : All-Silicone, with radiopaque line

2-WAY P.C. CONNECTOR

TROCAR NEEDLE

- Material : Stainless Steel
- Length : 130mm

CONNECTING TUBE

- Material : All-Silicone
- Length : 720mm

S-Silicone Container

S-Silicone Wound Tube

100,150,200,250,400 – Container Capacity

M-Medium (3.2mm)

L-Large (4.8mm)

+–Cross Type Wound Tube

JP – Jackson Pratt Wound Tube, Length : 7mm X 200mm

Negative Pressure : 120mmHg

Thank You !